



Sheraton[®]
SAN DIEGO HOTEL & MARINA



Floor Plans and Capacity Charts



Sheraton[®]

SAN DIEGO HOTEL & MARINA

Meeting Space Overview – Marina Tower

SHERATON SAN DIEGO HOTEL & MARINA BY THE NUMBERS

Total Guestrooms: 1,053 rooms / 52 suites

Total Meeting Rooms: 53

Maximum Group Size: 2,000

Total Meeting Space: 120,000 sq. ft. / 11,148 sq. mt.

Additional spaces for meetings and events, not displayed here, may also be available. Contact your hotel representative for more information.

MARINA TOWER LOBBY LEVEL

BALLROOMS

- Grande Ballroom
- Grande Foyer
- Harbor Island Ballroom
- Harbor Island Foyer
- Seabreeze
- Marina Rooms
- Spinnaker
- Maritime
- Executive Conference Rooms
- Bay View Lawn

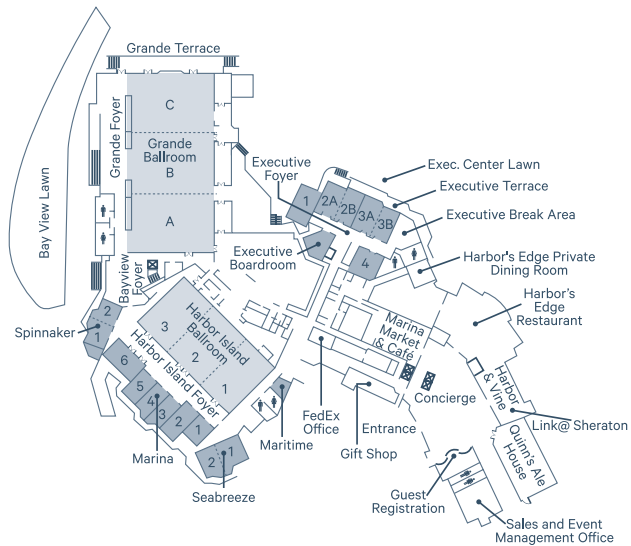

MARINA TOWER LOWER LEVEL

- Pavilion
- Nautilus
- Nautilus Foyer

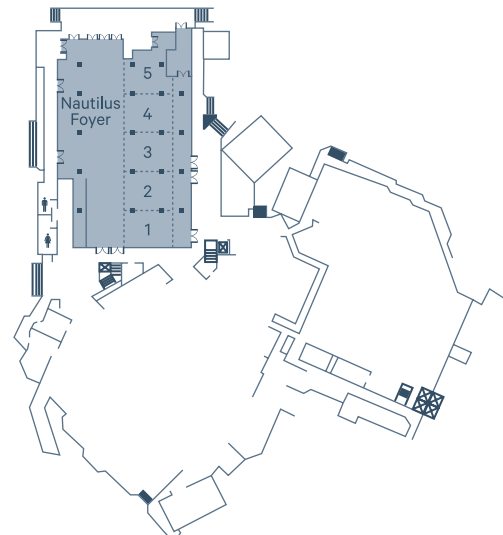

This document contains approximate measurements and square footage that are for illustrative purposes only. We cannot guarantee the floor plan accuracy or completeness, therefore encourage you to review the space to make sure it is suitable for your event.



Sheraton[®]

SAN DIEGO HOTEL & MARINA

Meeting Space Overview – Bay Tower

SHERATON SAN DIEGO HOTEL & MARINA BY THE NUMBERS

Total Guestrooms: 1,053 rooms / 52 suites

Total Meeting Rooms: 53

Maximum Group Size: 2,000

Total Meeting Space: 120,000 sq. ft. / 11,148 sq. mt.

Additional spaces for meetings and events, not displayed here, may also be available. Contact your hotel representative for more information.

BAY TOWER LOBBY LEVEL

Bel Aire Ballroom
Fairbanks Ballroom
Shutters
Carmel
Monterey
La Jolla
Del Mar
Bay Tower Lounge Restaurant

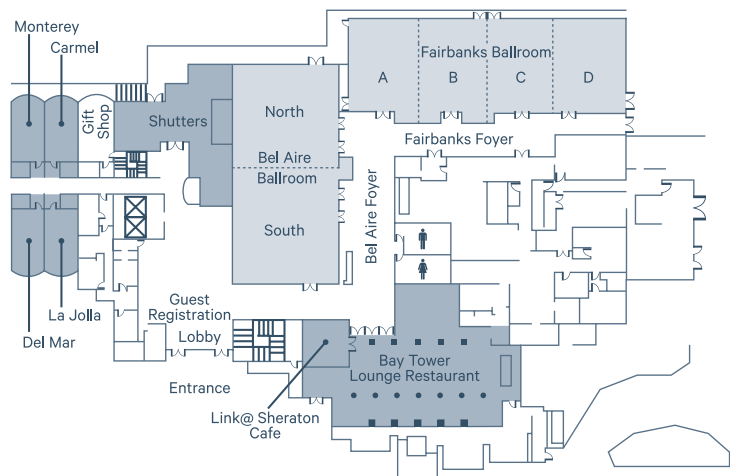

BAY TOWER FOURTH LEVEL

Catalina Ballroom
Catalina Terrace
Point Loma
Coronado

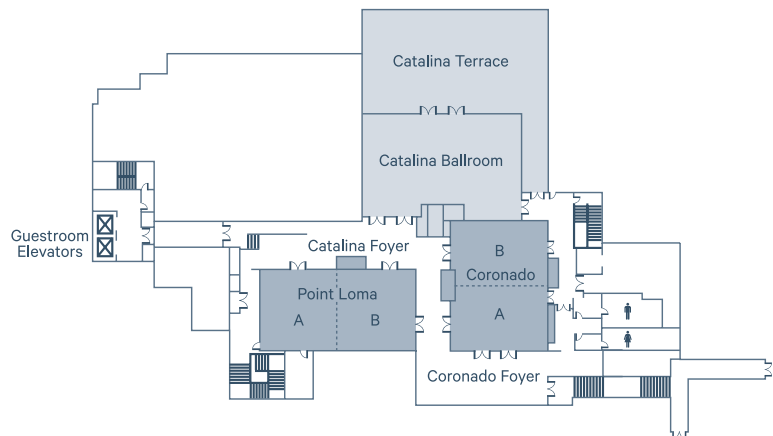

This document contains approximate measurements and square footage that are for illustrative purposes only. We cannot guarantee the floor plan accuracy or completeness, therefore encourage you to review the space to make sure it is suitable for your event.

SHERATON SAN DIEGO HOTEL & MARINA
1380 Harbor Island Drive
San Diego, California 92101
T 619 291 2900 F 619 692 2737
sheratonsandiegohotel.com



Sheraton[®]

SAN DIEGO HOTEL & MARINA

Meeting Space: Marina Tower

MARINA TOWER LOBBY LEVEL BALLROOMS

- Grande Ballroom
- Grande Foyer
- Harbor Island Ballroom
- Harbor Island Foyer
- Seabreeze
- Marina Rooms
- Spinnaker
- Maritime
- Executive Conference Rooms
- Bay View Lawn

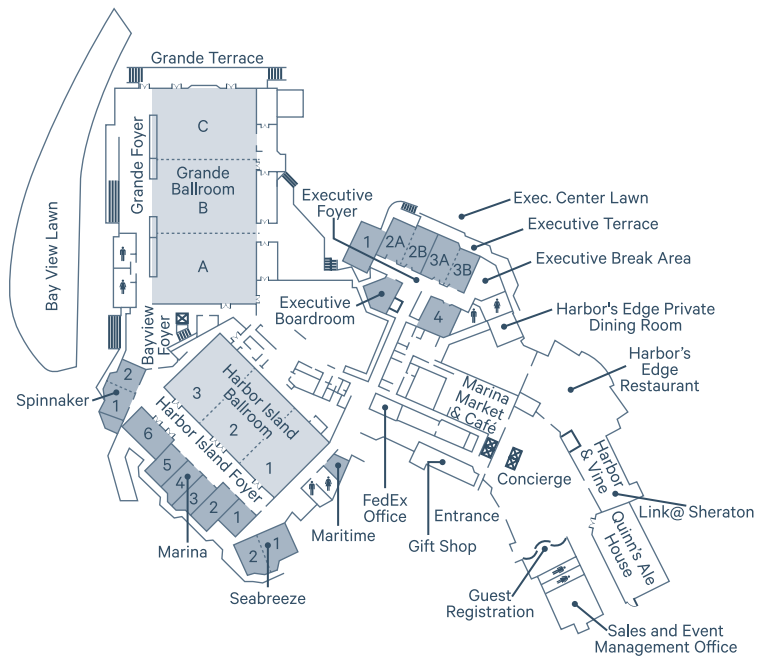

MARINA TOWER LOWER LEVEL

- Pavilion
- Nautilus
- Nautilus Foyer

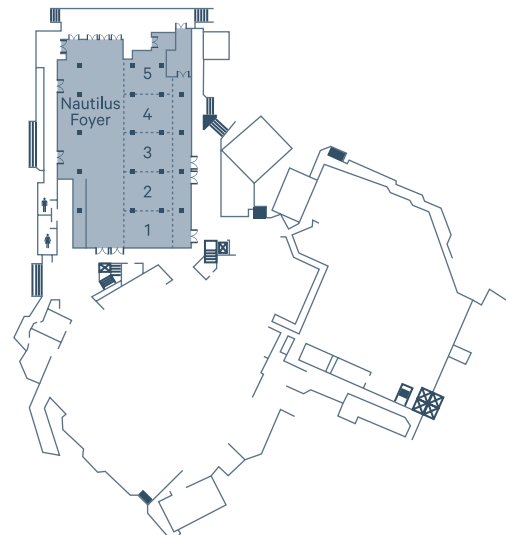
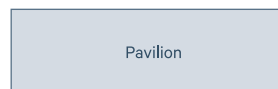



Sheraton[®]

SAN DIEGO HOTEL & MARINA

	SQUARE FEET	DIMENSIONS	HEIGHT	BANQUET	THEATER	CONFERENCE	RECEPTION	CLASSROOM	U-SHAPE	HOLLOW SQUARE	EXHIBIT BOOTHS
GRANDE BALLROOM	14,442	171' 3" x 84'	18'	1200	1500	-	2,100	1,008	-	-	72/75
GRANDE A, B, C	4,788	57' x 84'	18'	400	500	40	685	336	80	95	25/19
GRANDE FOYER	3,658	172' 8" x 33' 3"	-	-	-	-	1,000	-	-	-	-
HARBOR ISLAND BALLROOM	9,882	143' 2" x 70'	16'	900	1200	-	1,450	680	-	-	54/49
HARBOR ISLAND 1, 3	3,109	44' 6" x 70'	16'	290	350	60	475	220	70	80	16/12
HARBOR ISLAND 2	3,575	54' 2" x 66'	16'	320	350	54	475	240	70	80	16/12
HARBOR FOYER	3,117	145' x 30'	-	-	-	-	900	-	-	-	-
SEABREEZE	1,617	50' 9" x 35' 8"	10'	120	150	40	200	90	45	50	7/6
SEABREEZE 1	994	31' 6" x 35' 8"	10'	60	75	24	120	45	28	28	-
SEABREEZE 2	623	19' 3" x 35' 8"	10'	50	50	20	80	32	20	20	-
MARINA 1	609	26' x 23' 6"	10'	40	60	20	80	30	24	30	4/2
MARINA 2	746	40' x 18' 8"	10'	60	90	36	100	48	36	40	4/3
MARINA 3	725	32' x 18' 8"	10'	50	80	26	90	40	26	30	3/3
MARINA 4	725	32' x 18' 8"	10'	50	80	26	90	40	26	30	3/3
MARINA 5	616	30' 9" x 20'	10'	40	80	26	90	40	26	30	3/3
MARINA 6	1,134	43' 9" x 26'	10'	80	120	40	150	72	40	44	6/5
SPINNAKER	1,322	49' 4" x 28' 8"	10'	90	125	40	174	70	42	45	5/5
SPINNAKER 1	684	27' 9" x 28' 8"	10'	50	65	25	94	36	25	30	-
SPINNAKER 2	638	21' 7" x 28' 8"	10'	40	50	20	80	32	20	22	-
MARITIME	291	19' 3" x 15'	10'	10	24	10	-	-	8	10	-
EXECUTIVE BOARDROOM	585	27' 10" x 28' 4"	11' 6"	-	-	14	-	-	-	-	-
CONFERENCE 1	1,000	40' x 25'	11' 6"	70	90	30	70	54	30	35	-
CONFERENCE 2A	734	33' x 22' 3"	11' 6"	50	65	24	50	40	25	30	-
CONFERENCE 2B	759	37' 6" x 20' 3"	11' 6"	50	65	24	50	40	25	30	-
CONFERENCE 2A + 2B	1,594	42' 6" x 37' 6"	11' 6"	100	150	40	125	80	35	40	-
CONFERENCE 3A	787	37' 6" x 21'	11' 6"	50	65	24	50	40	25	30	-
CONFERENCE 3B	761	36' 3" x 21'	11' 6"	50	65	24	50	40	25	30	-
CONFERENCE 3A + 3B	1,575	42' x 37' 6"	11' 6"	100	150	40	125	80	35	40	-
CONFERENCE 4	907	34' 8" x 31' 6"	11' 6"	50	80	24	65	50	25	30	-
EXECUTIVE BREAK AREA	723	29' 6" x 34'	11' 6"	40	-	-	60	-	-	-	-
EXECUTIVE TERRACE	1,652	136' x 13'	-	20	-	-	150	-	-	-	-
EXECUTIVE LAWN	1,972	68' x 29'	-	130	-	-	200	-	-	-	-
PAVILION	20,000	200' x 100'	32'	1,600	2,000	-	2,400	-	-	-	114/93
BAY VIEW LAWN	12,000	-	-	1,000	-	-	1,200	-	-	-	-
NAUTILUS + FOYER	14,874	134' x 111'	10'	1,200	-	-	1,450	-	-	-	94/84
NAUTILUS 1, 2, 3 or 4	1,638	63' x 26'	10'	130	180	50	170	110	60	70	-
NAUTILUS 5	2,694	63' x 63'	10'	180	230	50	200	110	60	70	-
NAUTILUS FOYER	5,168	152' x 34'	10'	260	-	-	170	-	-	-	-
SHORELINE	3,249	57' x 57'	-	90	-	-	150	-	-	-	-
LANAI LAWN	3,870	90' x 43'	-	240/500	-	-	700	-	-	-	-
FOURTH + FIFTH FLOORS 411, 415, 511, 514, 515 or 518	485	25' 6" x 27' 6"	8'	30	35	20	45	18	16	-	-
HARBOR'S EDGE PDR	558	23' x 24'	10' 6"	40	-	-	40	-	20	25	-
H.E. UPPER LEVEL	2,017	65' x 31' 6"	12'	54	-	-	200	-	-	-	-
H.E. LOWER LEVEL	2,960	94' 6" x 31' 6"	16' 3"	132	-	-	200	-	-	-	-



Meeting Space: Bay Tower – Lobby Level

BAY TOWER LOBBY LEVEL

- Bel Aire Ballroom
- Fairbanks Ballroom
- Shutters
- Carmel
- Monterey
- La Jolla
- Del Mar
- Bay Tower Lounge Restaurant

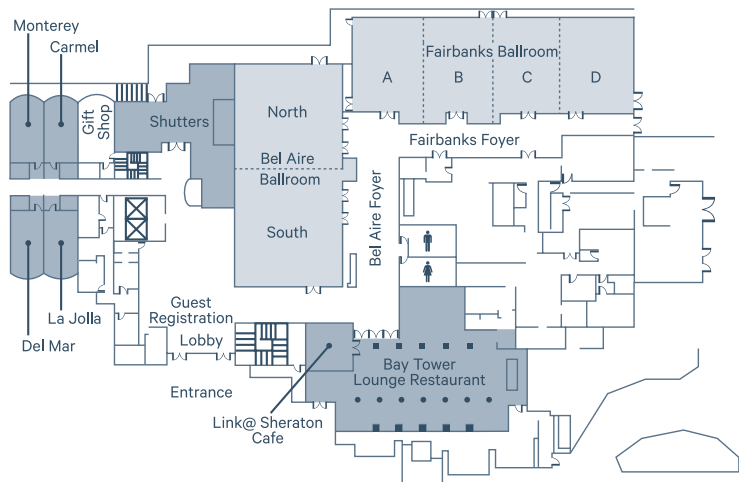

	SQUARE FEET	DIMENSIONS	HEIGHT	BANQUET	THEATER	CONFERENCE	RECEPTION	CLASSROOM	U-SHAPE	HOLLOW SQUARE	EXHIBIT BOOTHS
BEL AIRE BALLROOM	4,218	93' 3" x 45'	13' 6"	340	500	86	500	240	100	115	22/15
BEL AIRE NORTH	2,092	45' x 46'	13' 6"	160	240	40	250	115	54	65	9
BEL AIRE SOUTH	2,126	45' x 46' 9"	13' 6"	160	240	40	250	115	54	65	10
BEL AIRE FOYER	1,261	17' x 74' 2"	-	-	-	-	-	-	-	-	-
FAIRBANKS BALLROOM	4,600	120' x 38' 6"	9' 10"	360	450	108	500	260	120	132	25/19
FAIRBANKS A, B, C or D	1,150	30' x 38' 6"	9' 10"	80	100	25	125	65	34	44	6
FAIRBANKS FOYER	841	70' 1" x 12'	-	-	-	-	-	-	-	-	-
SHUTTERS	1,184	58' 9" x 48'	9' 9"	70	70	24	100	32	20	30	-
CARMEL	401	25' x 14'	7' 9"	20	40	20	40	15	-	-	-
MONTEREY	401	25' x 14'	7' 9"	20	40	20	40	15	-	-	-
LA JOLLA	401	25' x 14'	7' 9"	20	40	20	40	15	-	-	-
DEL MAR	401	25' x 14'	7' 9"	20	40	20	40	15	-	-	-
GARDEN TERRACE	3,549	28' x 126' 9"	-	280	300	-	400	-	-	-	-
BAY TOWER LOUNGE	2,012	94' 10" x 21'	8'	58	-	-	150	-	-	-	-
BTL PATIO	1,556	94' 5" x 34' 4"	8'	52	-	-	150	-	-	-	-



Sheraton[®]
SAN DIEGO HOTEL & MARINA

Meeting Space: Bay Tower – Fourth Level

BAY TOWER FOURTH LEVEL

Catalina Ballroom
Point Loma
Coronado

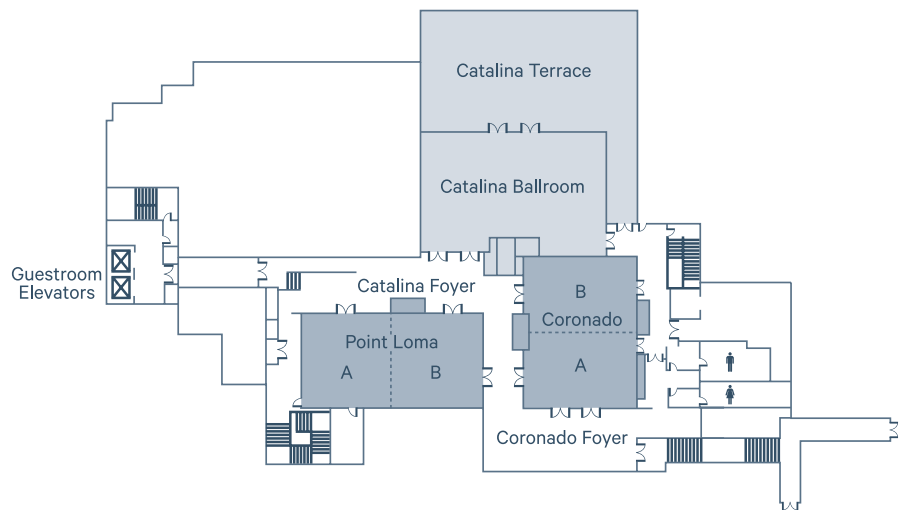

	SQUARE FEET	DIMENSIONS	HEIGHT	BANQUET	THEATER	CONFERENCE	RECEPTION	CLASSROOM	U-SHAPE	HOLLOW SQUARE	EXHIBIT BOOTHS
CATALINA BALLROOM	2,252	59' 8" x 39'	11' 7"	170	250	48	200	100	57	65	8
CATALINA TERRACE	2,586	66' x 39' 3"	-	100	-	-	100	-	-	-	-
CATALINA FOYER	805	59' 3" x 13' 7"	-	-	-	-	-	-	-	-	-
POINT LOMA	1,770	59' x 30'	11' 4"	150	180	48	200	90	57	60	8
POINT LOMA A or B	885	29' 6" x 30'	11' 4"	70	90	26	120	45	26	30	-
CORONADO	1,776	37' x 48' 2"	11' 1"	120	180	40	180	90	42	48	7
CORONADO A or B	888	37' x 24' 6"	11' 1"	60	90	26	90	45	26	30	-
CORONADO FOYER	869	48' 3" x 18'	-	-	-	-	-	-	-	-	-



Sheraton®

SAN DIEGO HOTEL & MARINA



SHERATON SAN DIEGO HOTEL & MARINA
1380 Harbor Island Drive
San Diego, California 92101
T 619 291 2900 F 619 692 2737
sheratonsandiegohotel.com

©2015–2016 Starwood Hotels & Resorts Worldwide, Inc. All Rights Reserved. Sheraton and its logos are the trademarks of Starwood Hotels & Resorts Worldwide, Inc., or its affiliates.